

This document contains proprietary information and such information may not be disclosed to others for any purposes, not used for sales/marketing/procurement purposes without written permission

REV	DESCRIPTION OF REVISION	TRL NO.	BY	DATE	APPROVED
A	Initial Release	—	H.wei	24/12/15	24/12/15

1 Electrical

- 1.1 Impedence
- 1.2 Frequency
- 1.3 VSWR

50 Ω  
 DC-18GHz  
 1.25:1

2 Environmental&Mechanical

- 2.1 Temperature range
- 2.2 RoHs Compliant
- 2.3 Durability

-40℃ ~ +85℃  
 >500 cycles

3 Materials&plating

- 3.1 Body:
- 3.2 Insulator:
- 3.3 Contact Pin:

Brass, Gold plated  
 Teflon  
 Beryllium-copper, gold plated

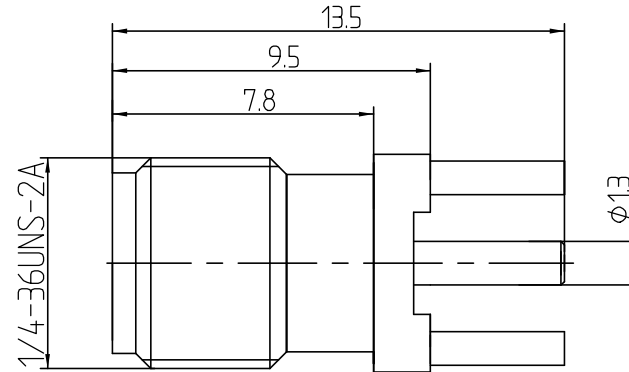

Recommended Mounting Hole

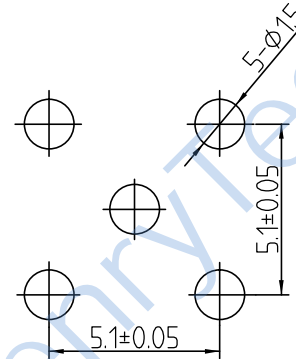

Tel: Lee +86-13890694956  
 Web: www.henglitaitech.com/cn

Notes:

- 1. ALL SPECIFICATIONS ARE SUBJECT TO CHANGE NOTICE AT ANY TIME
- 2. CUSTOMER OUTLINE DRAWING FOR REFERENCE ONLY

DRAWN: H.wei 24/12/15 ENGINEER: L.yu 24/12/15 APPROVED: W.yi 24/12/15 TOLERANCES UNLESS OTHERWISE SPECIFIED X ±0.50 .X ±0.20 .XX ±0.10 ANGLES ±1°	TITLE: RF Coaxial Connector SMA Female Connector PCB Mounted	
PART NO: HL-SMA-KHD	SIZE: A4 SCALE: N/A SHEET: 1/1 REV: A	DIMENSION IN MILLIMETERS (mm)